

IMPORTANT SAFETY INFORMATION

Please read this manual carefully and follow its instructions. Improper use or failure to follow these instructions could result in serious injury, property damage or death. Operators must be trained and instructed in the safe and proper use and maintenance of this product. Keep this manual for future reference.

The following signal words and meanings are intended to explain the levels of risk associated with this product.

- ⚠ DANGER:** Indicates a hazardous situation that, if not avoided, **WILL** result in serious injury or death
- ⚠ WARNING:** Indicates a hazardous situation that, if not avoided, **COULD** result in serious injury or death
- ⚠ CAUTION:** Indicates a hazardous situation that, if not avoided, **MAY** result in minor or moderate injury

INSTALLATION

MOUNTING

- ⚠ CAUTION:** **READ INSTRUCTIONS BEFORE USE** To avoid injury: all operators should be instructed in the safe, proper use and maintenance of this product.
- ⚠ WARNING:** Main support device must have break strength exceeding 6 times weight of load.
- ⚠ CAUTION:** Use new cotter pin when re-assembling clevis pin.
- ⚠ CAUTION:** Do not adjust mainspring tension until tool and attachments are suspended from retractor.
- ⚠ CAUTION:** Mounting retractor in wrong configuration, with cable pulling against guide, can cause premature cable wear and cable to jam inside retractor.

- Attach retractor to main support located above work area with upper mount (swivel fork) and clevis pin. - See **FIG.01**
- Secure clevis pin with washer and cotter pin. - See **FIG.01** for upper mount reference dimensions.
- **NOTE:** Support must allow swivel fork to pivot 30° from vertical axis, perpendicular to clevis pin axis.
- Sideways more than 30° or exceed free play between support and swivel fork – See **FIG. 02**

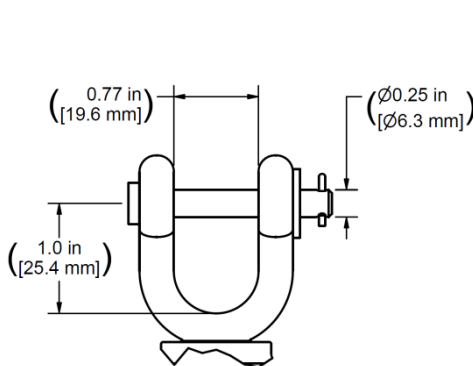

FIG. 01

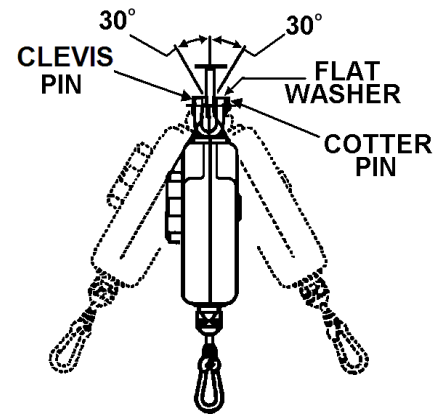

FIG. 02

SECONDARY SUPPORT

CAUTION: READ INSTRUCTIONS BEFORE USE To avoid injury: all operators should be instructed in the safe, proper use and maintenance of this product.

CAUTION: To avoid injury, always install secondary support [Safety Cable].

CAUTION: Do not install secondary support [Safety Cable] to same structure that supports the retractor.

- Secondary Support [Safety Cable with Adjustable Wire Clips] available from manufacturer as an accessory.
- Please follow all instructions provided in the Safety Cable Assembly Leaflet [S65-SSPBR] to properly attach the Safety Cable to the Unit. Leaflet [S65-SSPBR] is included with the Safety Cable.
- Attach other end of the secondary support [Safety Cable] to secondary support structure by means of Carabineer Hook and lock in place the carabineer nut – [See FIG. 03].
- Secondary support [Safety Cable] should be as short as possible but still allowing Unit Rotation without engaging or adding any load on the Safety Cable. The maximum length for the Safety Cable should allow the retractor to drop no more than 6" to 10" or 152mm to 254mm, if main support would fail.



FIG. 03

OPERATION

TOOL ATTACHMENT

CAUTION: READ INSTRUCTIONS BEFORE USE To avoid injury: all operators should be instructed in the safe, proper use and maintenance of this product.

- Always measure weight of total LOAD tool complete with hoses, cables and fittings] to make sure it is within Weight Capacity of Retractor printed on unit label.
- Lift LOAD [See - FIG. 04] to retractor and attach it to provided tool clip, making sure the spring-loaded latch of tool clip is closed.
- Extension cables are available for lowering the position of the tool without reducing active travel.

CABLE STOP ADJUSTMENT

- Adjusting cable stop is not recommended due to reduction in active travel distance - [See - FIG. 05].
- Detailed procedure on how to adjust the cable stop can be obtained by contacting techsupport@aero-motive.com
- If additional cable extension is required, extension cable assemblies are offered as accessory items.
- Special overhang cables with specific lengths & configurations are offered. Contact techsupport@aero-motive.com

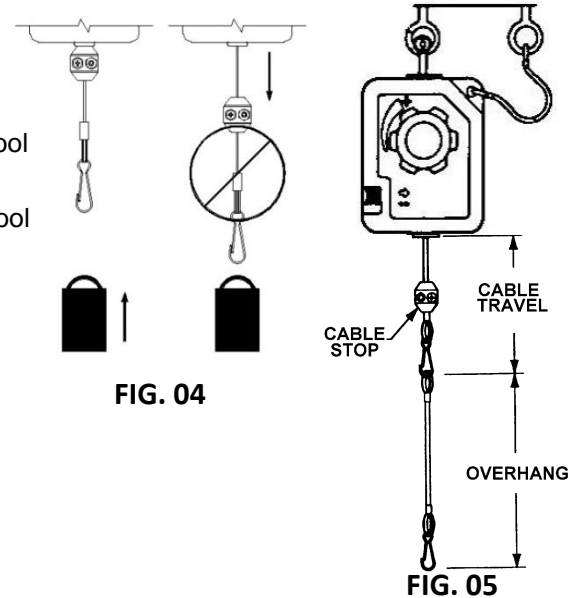

FIG. 04

FIG. 05

UNIT POWER SPRING TENSION ADJUSTMENT

CAUTION: READ INSTRUCTIONS BEFORE USE To avoid injury: all operators should be instructed in the safe, proper use and maintenance of this product.

WARNING: CABLE CAN RETURN SUDDENLY To avoid serious injury or death: Load MUST be fully attached to retractor before adjusting tension.

CAUTION: Do NOT Over-Tension retractor main spring. This will reduce cable travel and spring life.

Before making spring tension adjustments please check the following:

- Tool and all accessories are attached to lower tool clip.
- If tool attached to retractor cable descends, there is not enough tension on retractor mainspring.
- If cable stop is tight up against cable guide, there is too much tension on retractor main spring.

Unit Tension Adjustment

- To increase tension, turn Tension Knob (on the front of the retractor) clockwise or in the “+” direction until desired tension is achieved [See - FIG. 06].
- To decrease tension, HOLD main Ergo Knob and press black button in the lower left corner and release. Repeat until tool is at desired elevation [See - FIG. 06].
- After adjusting tension, pull cable to fullest extension to ensure proper travel is achieved. If cable does not reach full extension, some tension must be released. If proper tension and extension cannot be achieved, consult factory.

RATCHET LOCK - RFL6 & RFL8 ONLY

- Ratchet lock will engage in several tool locations. To engage ratchet lock, pull tool to desired location and let cable retract slightly. Ratchet lock will engage immediately.
- If ratchet lock does not engage, pull tool out further and try locking again.
- To disengage ratchet lock, pull cable out 6 in or 153mm and let cable retract fully.

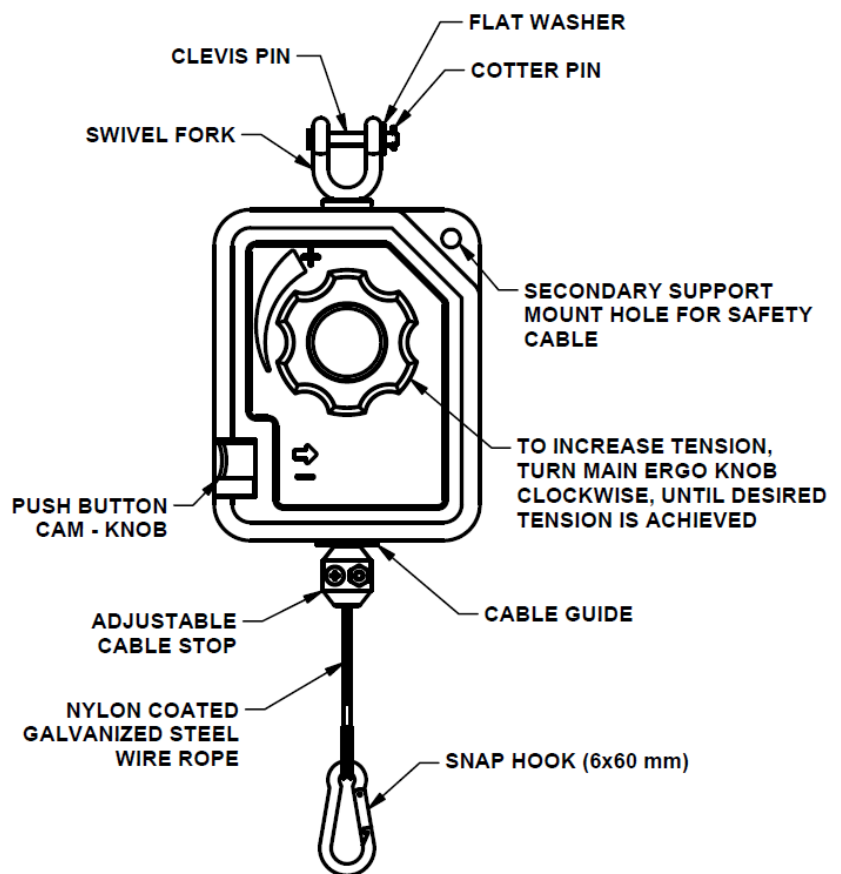

FIG. 06

SERVICE

CAUTION: This product is NOT SERVICEABLE and thus it is NOT to be disassembled.

Aero-Motive GmbH

Grünwalder Weg 30
82041 Oberhaching
Germany

Phone: +49 89 55875-700

Web Site

www.aero-motive.com

General Sales

info@aero-motive.com

Technical Support Group

techsupport@aero-motive.com

